



Waste Guide

Bixby, Malcolm, & Ryerson Hall residents are responsible for emptying their room waste. Keep this guide handy and refer to as needed.

Recycling & Compost

- ✓ Take to the bins located in the laundry room on floors 2-5.

Landfill

- ✓ Take to the landfill chute located outside the lounge on floors 2-5.

Cardboard Boxes

- ✓ Flatten and take to the cardboard collection bin located in the lobby on 1st floor. Never put cardboard down the chutes as they can jam and cause a safety & fire hazard.

eWaste & Reusables

- ✓ Bins are located at the Area Service Desk in Segundo Services Center.
- ✓ For large items, contact us for instructions.

Household Hazardous Waste

- ✓ Contact us for instructions.

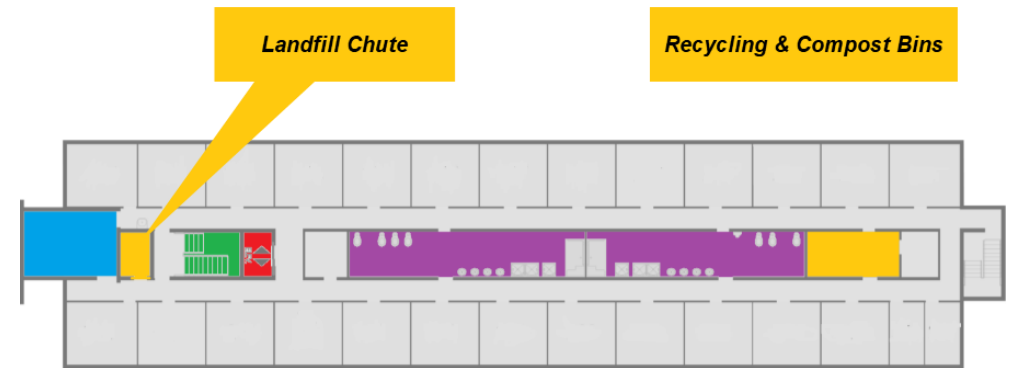

*** See reverse side for sorting tips**

Waste Location	
	Stairwell
	Elevator
	Lounge
	Bathrooms

Sort it out!

Recycling

Containers must be emptied of liquid and food residue

- ✓ Aluminum, steel, & tin cans
- ✓ Glass bottles & jars
- ✓ White & colored paper
- ✓ Magazines & newspapers
- ✓ Paperboard (e.g. Cereal box)
- ✓ Plastic containers identified with



Compost

- ✓ Liquid & food waste
- ✓ Compostable paper cups & food containers
- ✓ Compostable plastic & wood utensils
- ✓ Food soiled pizza boxes
- ✓ Compostable plastic containers identified with



Reusables

Gently used:

- ✓ School supplies
- ✓ Books
- ✓ Clothing & accessories
- ✓ Art & craft materials
- ✓ Video games
- ✓ Small working electronics

Landfill

- ✓ Packing Foam/Styrofoam™ identified with
- ✓ Plastic bags & film
- ✓ Food wrappers
- ✓ Plastic utensils & straws
- ✓ Soup & beverage cartons
- ✓ Empty aerosol cans



Electronic Waste (eWaste)

- ✓ Batteries
- ✓ Inkjet cartridges
- ✓ Cell phones & accessories
- ✓ Small non-working electronics

Household Hazardous Waste

- ✓ Non-empty aerosol cans
- ✓ Glues & adhesives
- ✓ Household cleaners
- ✓ Mercury thermometers
- ✓ Nail polish & remover
- ✓ Oil & latex paints
- ✓ Pharmaceuticals
- ✓ Solvents
- ✓ Syringes (containerized)
- ✓ Car fluids
- ✓ Unknown substances

The University of California has a goal to reduce waste 25% by 2025, 50% by 2030, and divert 90% of all waste from the landfill. Help UC Davis achieve this goal and reduce, reuse, & sort your waste!